

PARKANSON BANDSAWS

*Heavy Duty  
Semi-Auto Double Mitre  
Cutting Bandsaw*

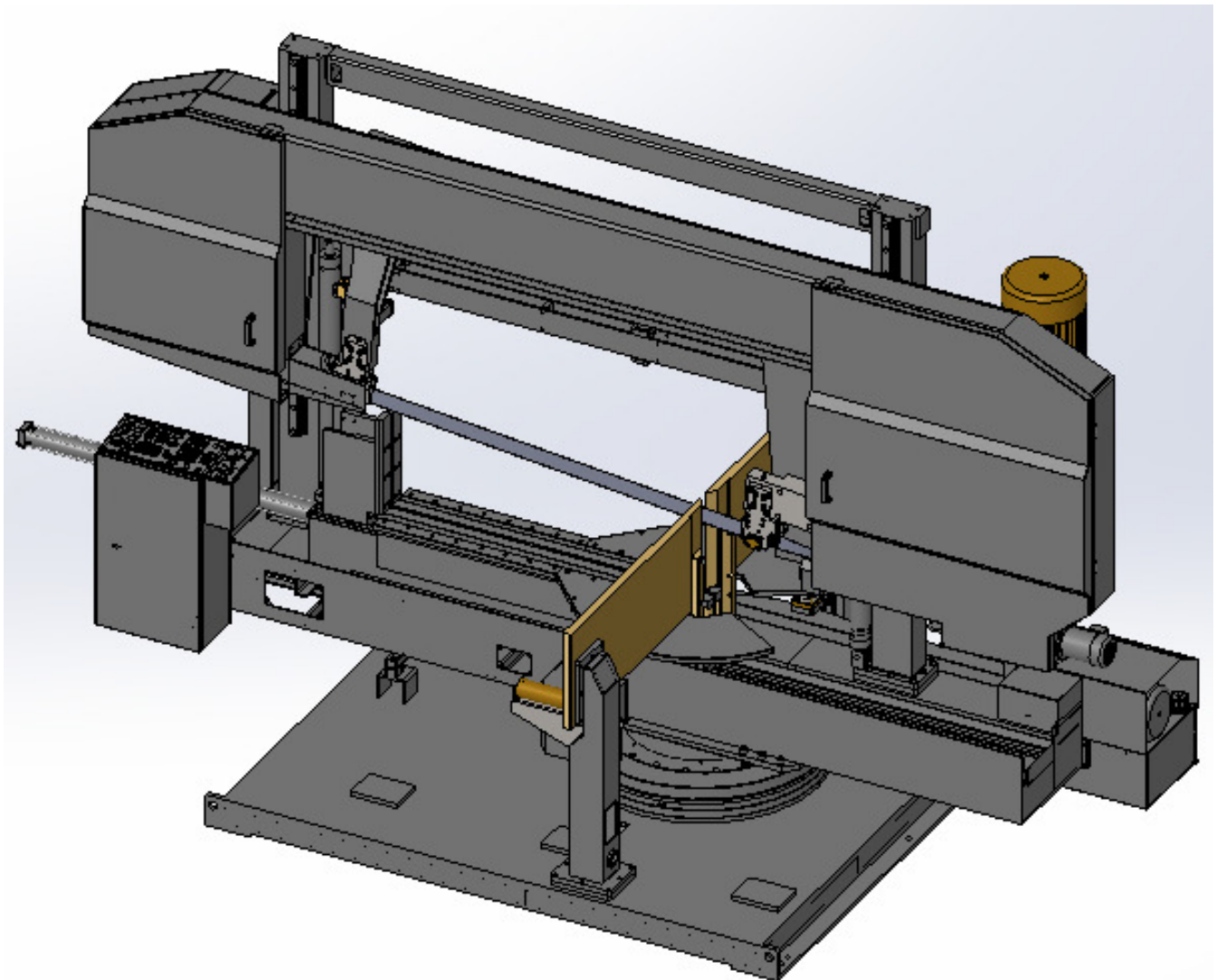





Model: PK1300DMS



## Features

1. For cutting any angle from 60° forward to 60° backward.
2. **NC/Manual mitre positioning with digital readout.**
3. The rotary center is at the intersection point of the saw blade and the fixed vise jaw.
4. **Inclination of the saw blade (5°) to reduce the initial blade impact when cutting beams.**
5. Columns with linear guideway.
6. **Automatic positioning of guide arm.**
7. Return of saw bow to starting cutting position or stop to bottom when cut of material.

## Specifications

Model		PK1300DMS
Cutting Capacity (mm)		760 (30")
		700x1300 (25.6"x51.2")
	 45° Left	650x850 (25.6"x33.5")
	 60° Left	650x550 (25.6"x21.6")
	 45° Right	650x850 (25.6"x51.2")
	 60° Right	650x550 (25.6"x21.6")
Motors	Saw Blade	10KW (15HP)
	Hydraulic	2.2KW (3HP)
	Coolant	0.2KW (1/4HP)
Blade Size		9300x67x1.6 (366.1"x2.63"x 0.063")
Blade Speed (M/min)		20-90 (65-295 ft/min)
Vise Clamping Width		150-1340mm (6"-52.7")
Working height (mm)		865 (34")
Dimensions (mm)	Length	2300 (90.5")
	Width	4350 (171.3")
	Height	2700 (106.3")
Net Weight (Approx.) Kg		7400 (16280 lb)

\* The specifications subject to change without notice

### Standard equipment

1. Inverter blade speed drive
2. Hydraulic blade tension.
3. Laser liner
4. Vise pressure regulator
5. Working light.

### Optional equipment

1. Mist lubrication
2. Top clamp
3. Full high vise jaws
4. Lifting roller
5. Roller table
6. Powered roller table



Capital Equipment Machinery Sales  
 1/10 Renewable Chase  
 Bibra Lake WA 6163  
 Ph: (08) 9410 9500 Fax: (08) 9410 9555  
 www.capitalequipment.biz